

| | |
|--|---------------------|
| Project | |
| Rothbury First School, Rothbury, Northumberland | |
| Scheme Name | |
| New Outdoor Facilities | |
| Drawing Name | |
| Overall View (NTS) | |
| Date | |
| November 2010 | |
| Rev | Date |
| Ref Number | Purpose of revision |
| 2602LT10 | - |

Please note: drawings are for illustration purposes only and are not to scale unless stated otherwise. Do not scale off this drawing. Where Honeycomb Lawn Matting in shown, area includes anchor matting (width 250mm) to perimeter, unless stated otherwise.

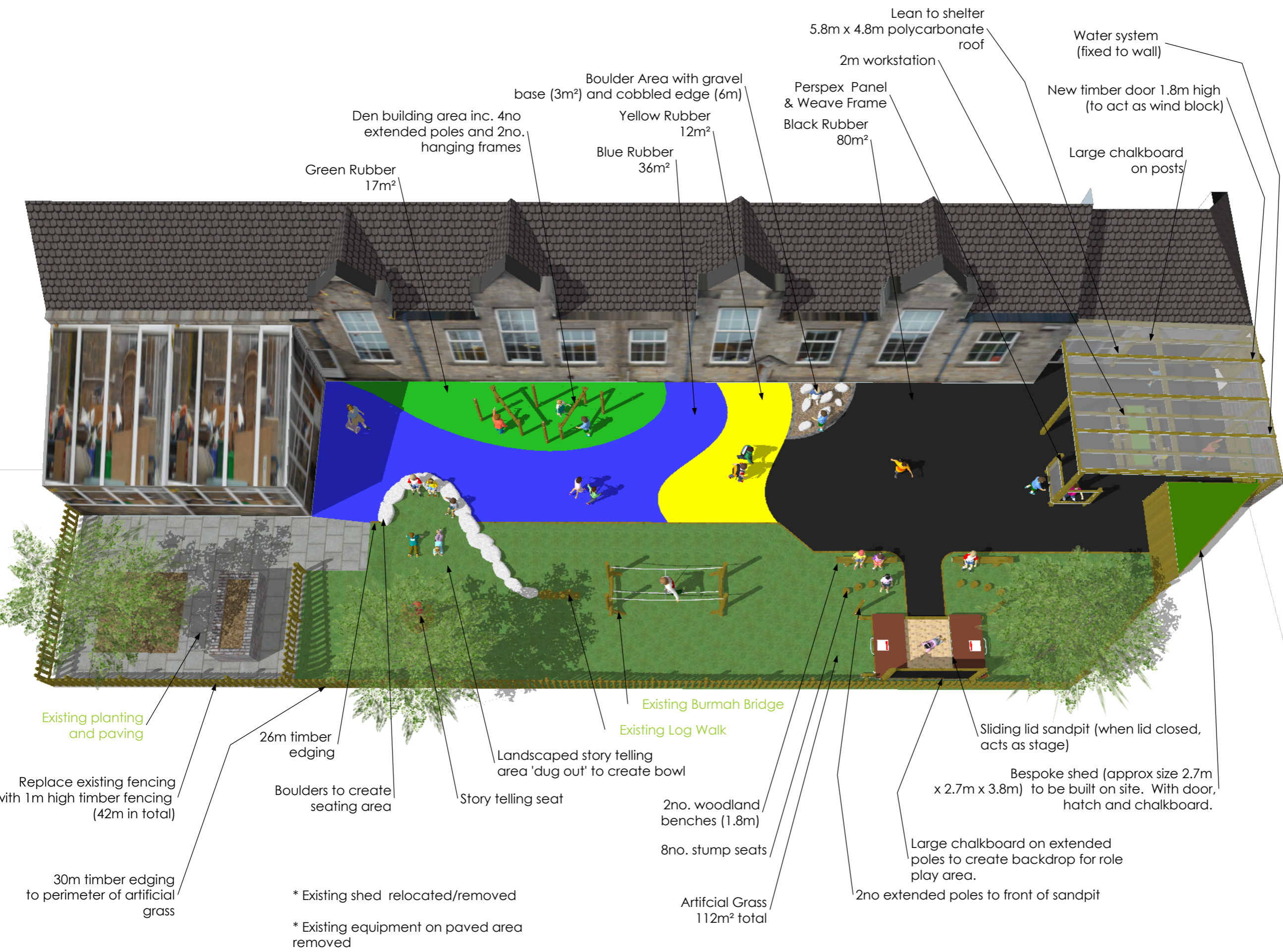

* Existing shed relocated/removed
 * Existing equipment on paved area removed