

PLAN VIEW

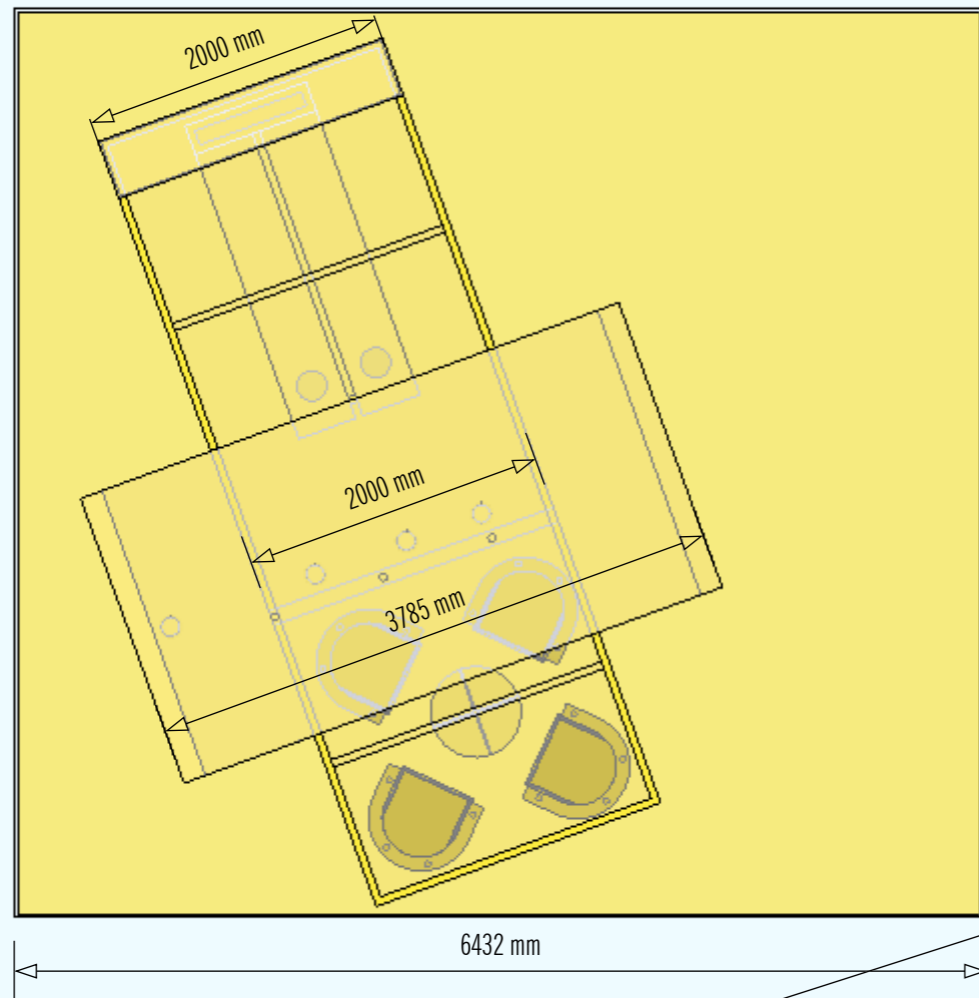

ALIGNED ELEVATION - USING 'ALIGN VIEW' TO SURFACE IN SU

THESE MEASUREMENTS WERE TAKEN ACROSS THE TOP & ACROSS THE BOTOM OF THE VERTICAL CENTRE PANEL BUT ARE READING DIFFERENTLY

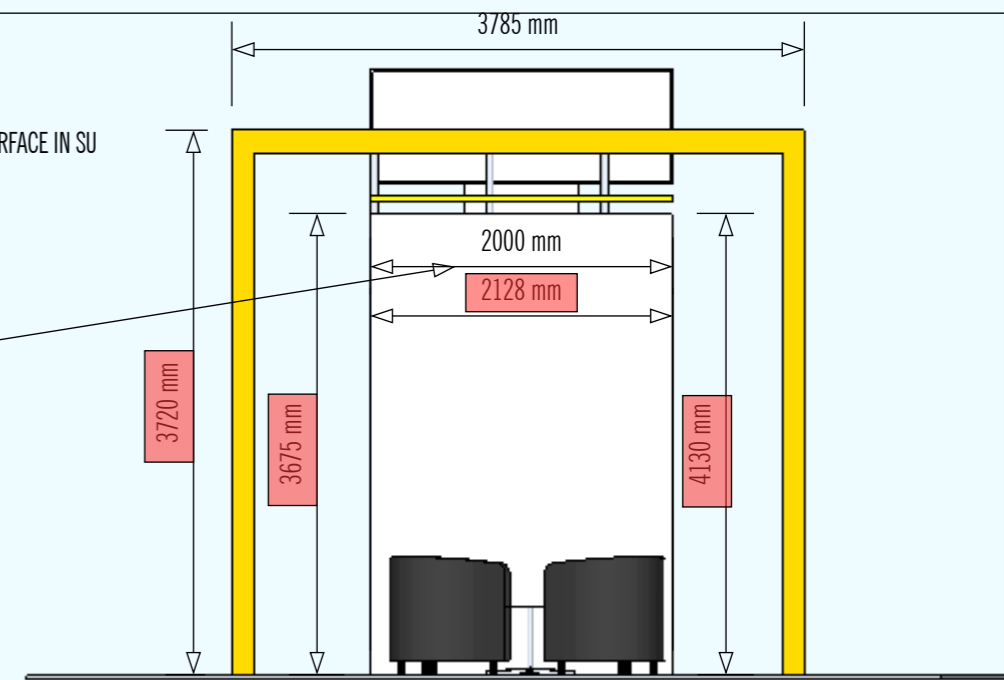

ALIGNED ELEVATION - CREATED WITH SCOTION PLAN IN SU (SECTION PLAN DISPLAY - OFF)

HEIGHT OF CENTRE PANEL IS PICKING UP ELEMENTS 'BEHIND' THE PANEL IN THE MODEL, SO MIS-CALCULATING MEASUREMENTS

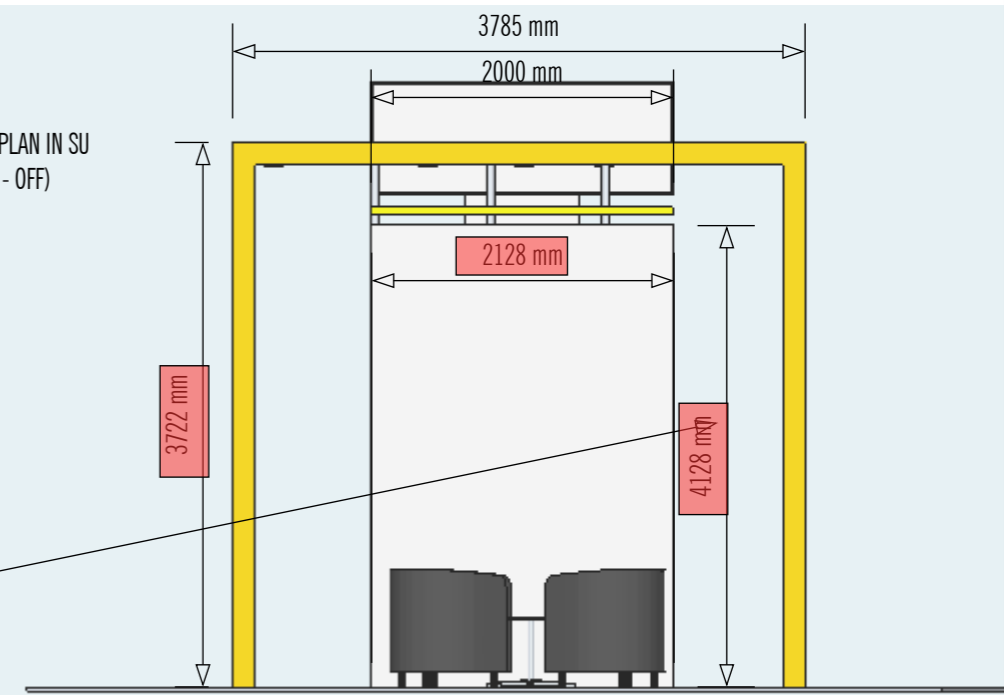

FRONT ELEVATION

DIRECT, FRONT ELEVATION - GIVES CORRECT MEASUREMENTS

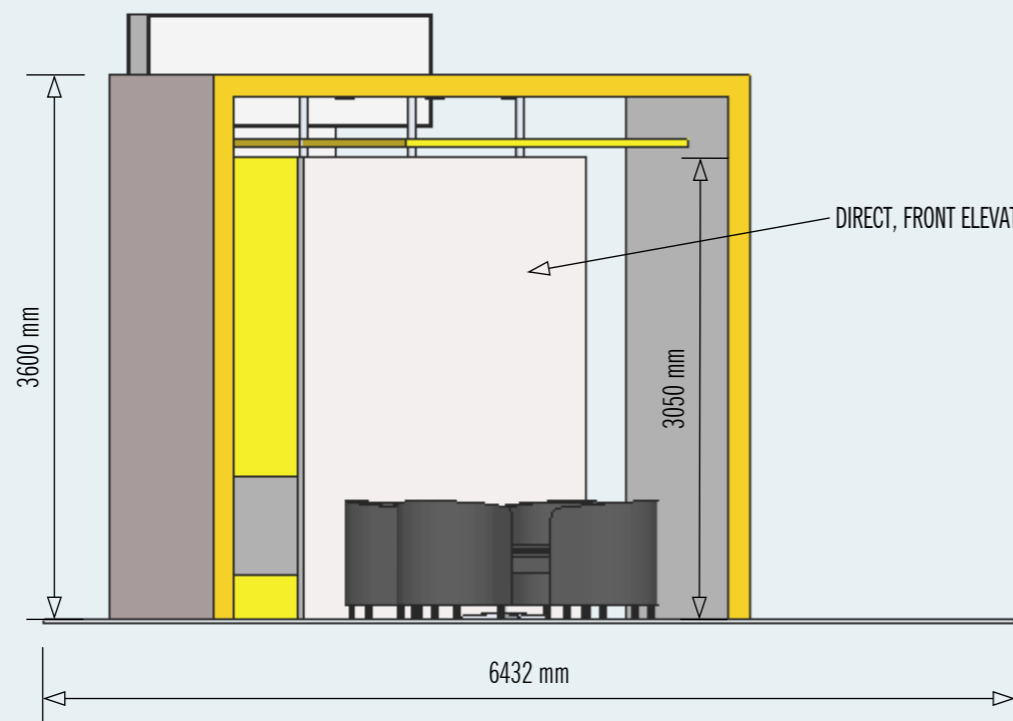

ALIGNED ELEVATION - CREATED WITH SECTION PLANE IN SU (SECTION PLANE DISPLAY - ON)

ALL DIMS SHOWN IN RED BOXES ARE IN CORRECT

